

Compare and you will choose
Burton's SUPER EXAM 50[®]LED



burton[®]
Luxo Medical Products

SUPER EXAM 50[®]LED COMPARATIVE DATA

	Burton Super Exam 50 [®] LED	Burton Super Exam 50 [®]
Intensity @ 24" (Lux)	39,000	45,700
Light Source	Light Emitting Diode	Halogen MR-16
Chromaticity	4300	3800
CRI	92	99
Wattage (W)	15	50
Rated Average Life (Hrs.)	40,000	4,000
Arm Range	42"	42"

* Estimated or measured

SUPER EXAM 50[®]LED RANGE OF MOTION

SUPER EXAM 50[®]LED CEILING
(arm movement same as wall and rail mounts)

SUPER EXAM 50[®]LED FLOOR
(arm movement same as table mount)

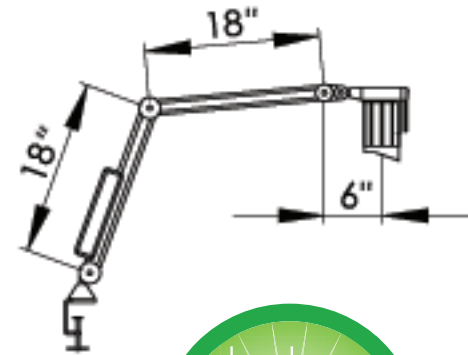
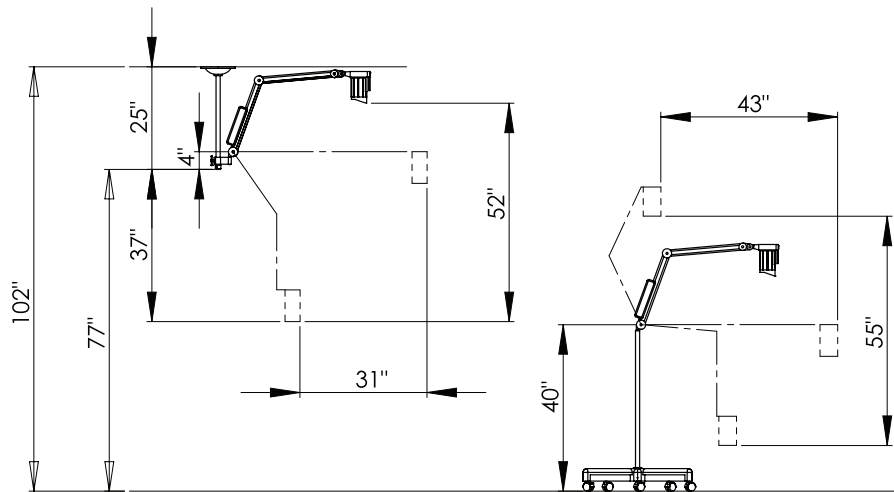

SUPER EXAM 50[®]LED

PERFORMANCE RELIABILITY VALUE

1. Super Exam 50 [®] LED	2. Select Model	3. Select Country/Region Code
<input type="checkbox"/> SE50L	<input type="checkbox"/> FL - Floorstand	<input type="checkbox"/> 00 - US: Hospital Grade
	<input type="checkbox"/> SC - Single Ceiling Mount	<input type="checkbox"/> 01 - Japan: NEMA 5-15P
	<input type="checkbox"/> R - Fairfield Rail Mount	<input type="checkbox"/> 02 - UK: BS1363
	<input type="checkbox"/> R1 - DIN 25mm Rail Mount	<input type="checkbox"/> 25 - EU: Shucko CEEE7/7
	<input type="checkbox"/> T - Table Mount	
	<input type="checkbox"/> W - Wall Mount	

Example: SE50LSC25 - Super Exam[®] LED Single Ceiling Mount EU Model



burton[®]

Luxo Medical Products

BURTON MEDICAL
An ISO Certified Company
21100 Lassen Street
Chatsworth, CA 91311
USA
Phone: 800-444-9909, 818-701-8700
Fax: 800-765-1770, 818-701-8725
www.burtonmedical.com



Introducing the best combination of natural white LEDs and drift-free positioning of any high intensity, diagnostic light in the market.

The Right Light

DIAGNOSTIC

The Right Light

SUPER EXAM 50[®] LED

Burton's Super Exam 50[®] LED delivers natural white light, best-in-class intensity, energy savings and longevity – all on a highly-positionable K-arm.

The Super Exam 50[®] LED is ideal for diagnostic purposes and medical examinations. Delivering higher illumination in a precisely controlled beam is just the beginning. Delivering value through longer life, lower energy consumption and versatility is where the Super Exam 50[®] LED really shines. The LED technology in this highly engineered optical system delivers the precisely controlled natural white light that is so important for an accurate diagnosis. The exclusive K-arm technology delivers versatility and drift-free positioning which makes it easy to use and dependable. Together the Super Exam 50[®] LED is an ideal solution for your practice whether its obstetrics, gynecology, dermatology or emergency medicine.



Burton has taken its 80 plus years of producing the healthcare industry's finest lighting instruments to new levels with the launch of its LED series. Utilizing only 15 watts of power, the Super Exam 50[®] LED produces the light output equivalent to 50 watts of conventional lighting. That represents a 70% savings! Rated at 40,000 hours of life, the Super Exam 50[®] LED lasts 10 to 20 times as long as conventional diagnostic products. It is no wonder why LED technology is sweeping the healthcare market and Burton is there leading the way.



Drift-free K-arm provides better positioning than goosenecks



Specially designed light head reduces surface temperature



Long lasting, energy efficient LED light source



SUPER EXAM 50[®] LED FEATURES:

- > Natural white light
- > LED light module with 40,000 hour life
- > High intensity of 39,000 Lux at 24"
- > 4000 K color temperature
- > CRI (Color Rendering Index) of 92
- > Universal input voltage
- > Drift-free K-arm with 42" arm range
- > Floorstand, Wall, Rail Mount, Ceiling Mount and Table Mount configurations
- > Rail mount bracket that can be attached to a bed rail or wall rail
- > 5-year warranty
- > IEC 60601-1/ 60601-2-41 Certified
- > CE approved

K-ARM TECHNOLOGY

Medical products are used in a dynamic environment and need a great level of flexibility. Friction-based arms with tightening screws make movement a problem. If you loosen a friction screw too much, the arm will collapse! That's why Burton's Super Exam 50[®] LED uses a unique, self-balancing K-Arm. No other arm in the market offers this kind of extensive reach. Internal springs ensure smooth, easy positioning, and that the arm will stay in the correct position without drifting.

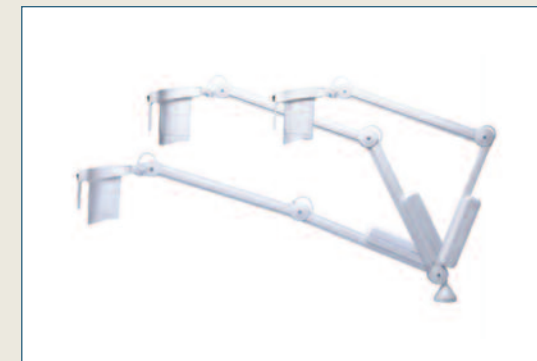

ARMS FOR HORIZONTAL MOVEMENT

Designed for maximum movement in the horizontal plane. Typical applications: Floorstand, table mounted.



ARMS FOR VERTICAL MOVEMENT

Designed for maximum vertical movement. This type of arm has more vertical movement than arms found on large operating lights. The arm will always tilt forward to avoid collisions with the wall. Typical applications: Wall mounted, ceiling mounted, rail mounted.