

EC2060

Blanket Warming Cabinet



**20.6 ft³ (0.58m³)
interior capacity**

Windowed doors

37-93°C (98-200°F) range

Deluxe electronic control

24-hour timer (single
programmable "off" period)

Epoxy-coated blanket
support assembly

Seismic wall mount
bracket kit is OSHPD
approved (#OPM-0067-13)

EC2060 Blanket Warming Cabinet

Specifications:

This warming cabinet is designed to elevate blanket temperatures to a level which will increase patient comfort.

The warming cabinet is constructed with stainless steel exterior casing and door with handle and hinges designed to withstand heavy usage. A door with window allows observation of inventory with the door closed. The cabinet is warmed using low-heat-density electrothermal cable array. The electrothermal cable is positioned in the floor and two sides of the warming cabinet, providing even heating of the interior chamber.

The cabinet is equipped with one (1) epoxy-coated blanket support assembly and one (1) center shelf per door opening. The cabinet is furnished with one (1) set of 5" (127mm) heavy duty casters, two with locking brake.

Control:

The temperature of each chamber is regulated by an electronic control consisting of a 4 digit L.E.D. display, ON/OFF button, INCREASE and DECREASE buttons, integrated control lock-out feature, timer and a series of prompt sequence indicators. The design and operational characteristics of the cabinet eliminate the need for a heat circulating fan.

The electronic control can easily be set to operate in Fahrenheit or Celsius. After a power failure, the cabinet will remember its programming and begin to operate as before. The ON/OFF indicator will blink to indicate a failure occurred; pressing the ON/OFF button once will eliminate this blinking. A thermal shut-off system, separate from the electronic control, is included as an additional safety feature.

The control will display temperature in whole degrees.

The electronic control has an adjustable temperature range of 37° to 93°C (98° to 200°F).

The TIMER feature allows the user to program the control to automatically turn on and turn off once during a 24 hour period at selected times. This enables the chamber to be shut off automatically at night to save energy, but to turn on again in the early morning to ensure warm blankets are available.

Special Information:

- Right hinging is standard.
Left hinging is available as a special order.
- Windowed door is standard.
Solid door is available as a special order.
- Pass-through design is available.

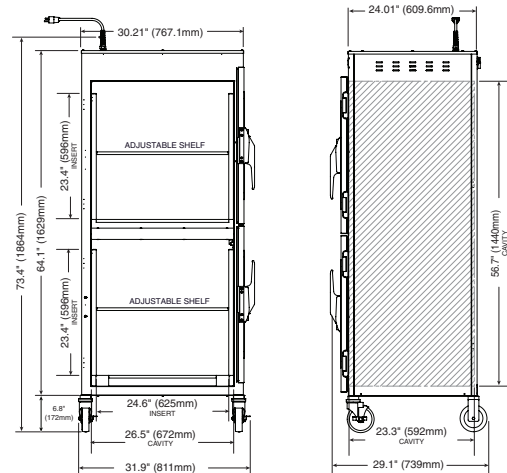
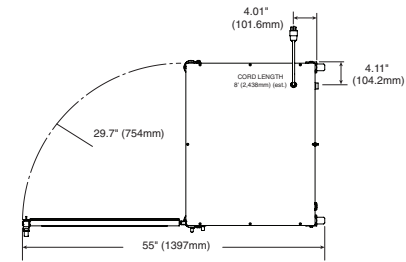

Capacity and Weights

Interior Capacity	20.6 cubic feet (c. 58m ³)
Net Weight	347 lb (157 kg)
Ship Weight	462 lb (210 kg)

Electrical

120 V.A.C. — 50/60 Hz, 1 ph
1.7 kW, 15 Amps
Safety Class I Equipment
No Applied Parts
Mode of Operation: Continuous



NEMA 5-20P
20A - 125V Plug
Hospital Grade



230 V.A.C. — 50/60 Hz, 1 ph
1.7 kW, 7.4 Amps
Type B Equipment



BS 1363 Plug*
(UK only)



CEE 7/7*
220-230V Plug



*Other international plugs are available, contact factory for more information.

Options and Accessories

Bracket Kit for Seismic Wall Mount (OPM-0067-13) {special installation requirements apply; see Bracket Kit spec }	CONTACT FACTORY
Built-in Trim Kit	5013968
Leg Kit, 6" (152mm)	5017084
Lock for Door Handle	LK-22567



ENTHERMICS MEDICAL SYSTEMS

An ISO 13485:2003 certified company

PO Box 443, Menomonee Falls WI 53052-0443

W164 N9221 Water St, Menomonee Falls WI 53051

Tel 262-251-8356 | 800-TO-B-WARM

generalinfo@enthermics.com

www.enthermics.com